



**Unicla**



**UP200/UX200  
Compressor  
Service Manual**

# UP200/UX200 Compressor Service Manual

## Table of contents:

### 1. Specifications

UP330/UX200 .....	1
Magnetic clutch .....	2

### 2. Component part list

I. Compressor part numbers .....	3
II. Exploded view .....	4

### 3. Service

Service tools part numbers .....	5
Bolt torque specifications .....	5
Service tools .....	6
Disassembly and reassembly procedures .....	7
Magnetic clutch installation .....	8
Removal of lip seal .....	9
Installation of lip seal .....	9
Installation of lip seal continued .....	10
Disassembly of the body.....	10
Assembly of the body.....	11
Assembly of the body continued .....	12
System oil quantity .....	13
Oil type and grade .....	13



**Copyright ©2007 All rights reserved**

No part of this document shall be reproduced in whole or in part without the permission of Unicla International Ltd. This includes reproduction or copies in any form or by any means including photocopying, printing or electronic media.

#### **IMPORTANT DISCLAIMER**

This is a guideline document containing professional information using representative graphs, charts and tables. Manufacturers' specifications must be consulted for specific guidelines and performance data. Unicla published data, specific to all models, is available in promotional literature and from Unicla International Ltd on request or through your Unicla supplier. Unicla International Ltd expressly disclaims all and any liability and responsibility to any person or business as a result of any actions taken on the basis of information in this publication.

## Compressor UP200

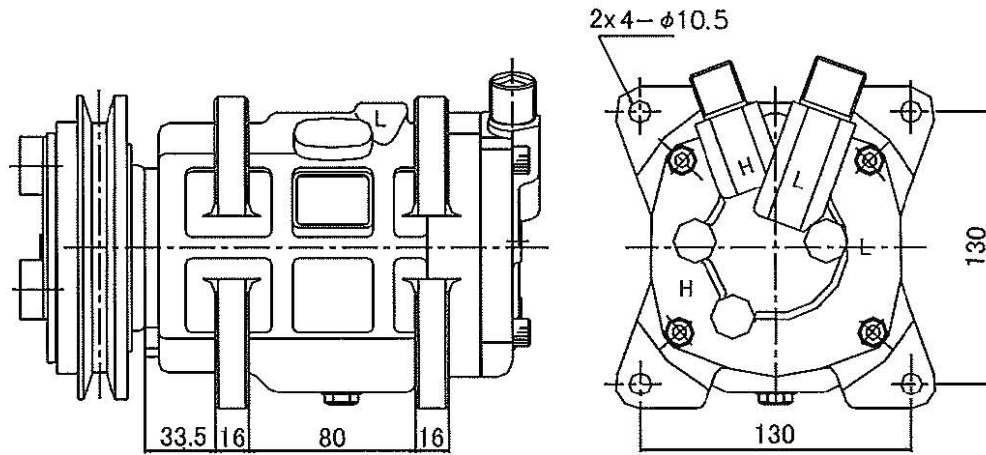

## Compressor UX200

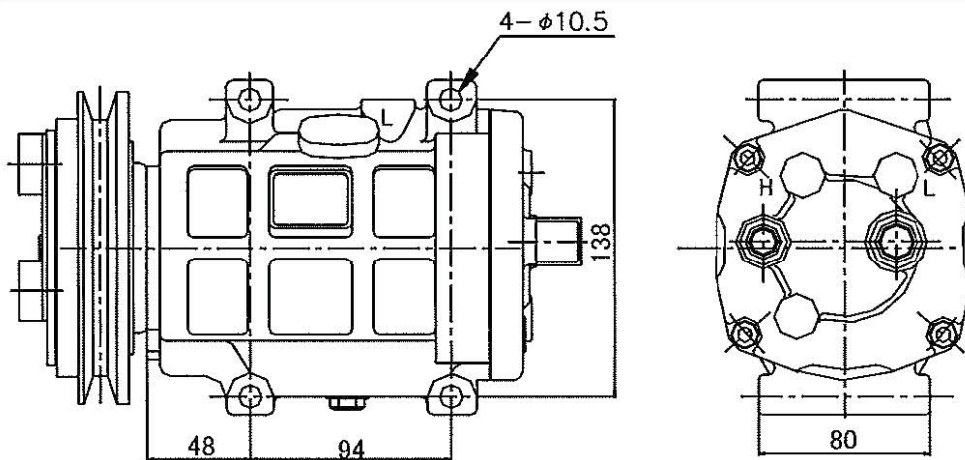

Compressor Model	UX-200 / UP-200
Number of cylinders	10
Displacement	200.4 cc/rev
Refrigerant	HFC-134a
Initial oil charge	180 cc
Oil type	Unidap 7 (PAG oil)
Weight without clutch	7.6 kg

## Magnetic clutch

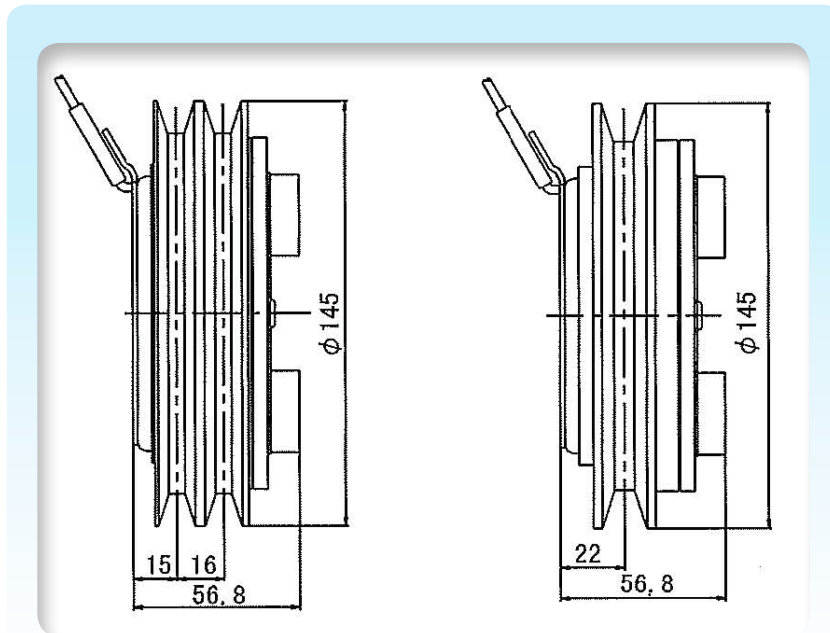

Part No	Rating	Revolution	Belt type	Weight
27201-000860	DC24v, Max 43w	CW	A	2.9kg
27201-000870	DC24v, Max 43w	CW	B	2.9kg

## Rear cap

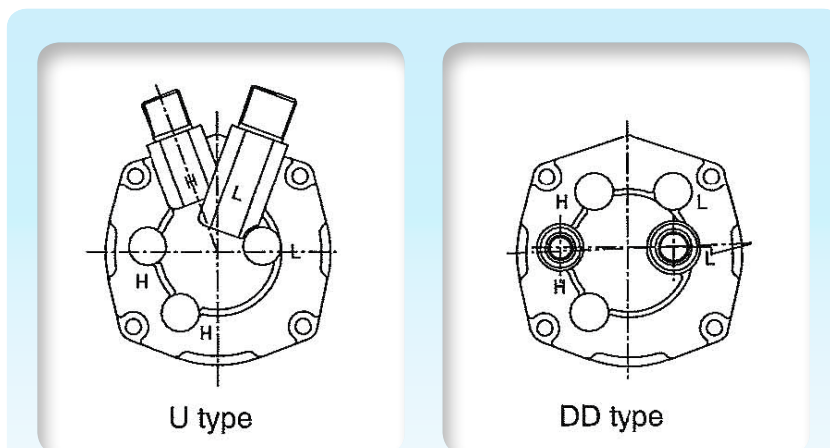

U Type	DD Type
21503-000020 (O ring)	21504-000020 (O ring)
21502-000020 (Flare)	21504-000030 (Flare)

## Compressor parts

No.	Description	Part number	Qty
1	Body UX200	21405-000020	1
2	Body UP200	21405-000020	1
3	Working assembly	22010-000110	1
4	Suction valve	22602-000040	1
5	Valve plate assembly	22602-000020	2
6	Gasket	93204-000050	2
7	Lip seal	92503-000030	2
8	Spacer	93501-000200	1
9	Snap ring	92404-000010	1
10	Felt	11950-10400	1
11	Plug	13201-000010	1
12	O-ring	92501-000120	1
13	O-ring	92501-000240	4
14	Rear cap	20503-000020	1
15	Charge valve assembly (H)	38101-000030	1
16	Charge valve assembly (L)	38101-000020	1
17	H Cap	12901-000030	1
18	L Cap	12901-000020	1
19	Relief valve	38305-000011	1
20	O-ring	92501-000060	1
21	Bolt M8 x 30	91916-08030	4

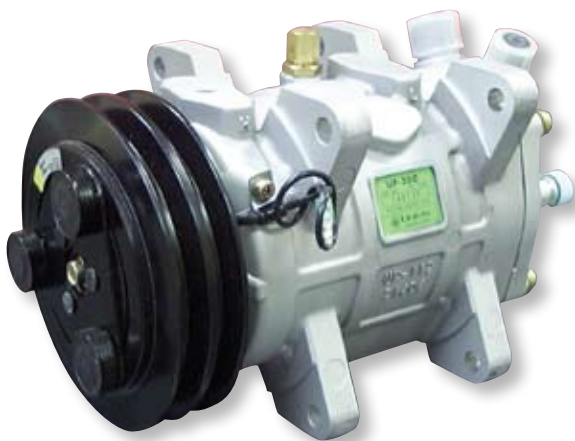

Exploded view

# UX200/UP200

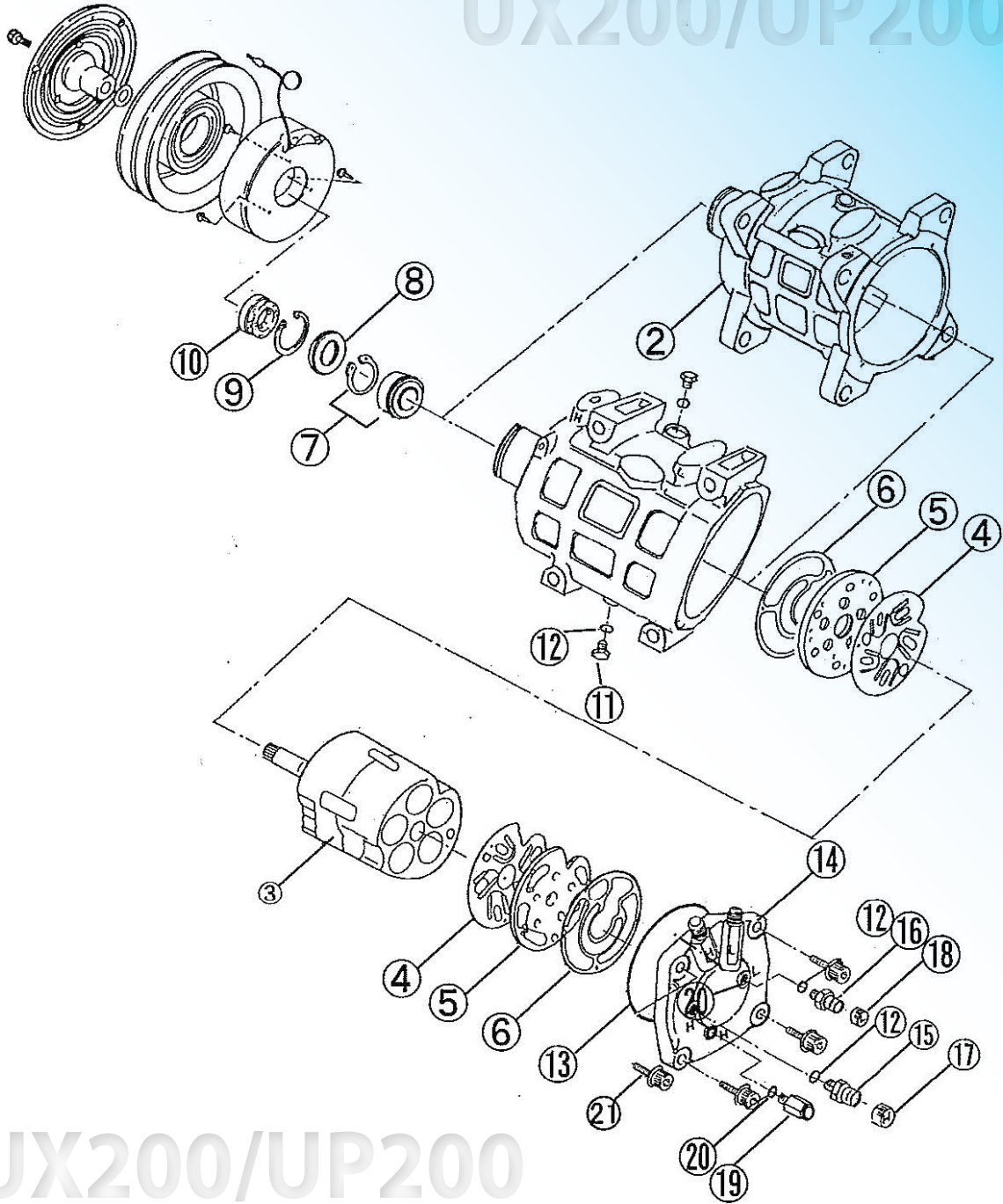

# UX200/UP200

## Service tool part numbers

No.	Description	Part number
1	Working bench	03301- 000750
2	Stand	03301- 000530
3	Working bench	03301- 000760
4	Stand	03301- 000770
5	Stand	03301- 000540
6	Remover, seal plate	03301- 000580
7	Installer, ring	03301- 000600
8	Shaft rotating handle	03301- 000610
9	Guide pin	03301- 000360
10	Guide sleeve	03301- 000620
11	Installation pulley	03301 - 000740
12	Hexagonal socket	03301- 000640 M8
13	Socket	03301-000650 M6
14	Clutch wrench	03301-000710
15	Torque wrench	03301- 000380
16	Snap ring pliers ( <i>Shaft</i> )	03301- 000430
17	Snap ring pliers ( <i>Hole</i> )	03301- 000420
18	Remover, pulley	03301-000410
19	Plastic hammer	03301- 000390
20	Thickness guage	03301- 000400

## Bolt torque specifications

Description	Bolt diameter (mm)	Tightening torque (N•m)
Housing cap bolts	M10 x P1.5	34.3 ± 1
High/low service valve	M12 x P1.0	11.7 ± 1
High/low pressure port	M8 x P1.25	24.5 ± 1
Clutch coil bolts	M6 x P1.0	5.9 ± 1
Clutch armature bolts	M8 x P1.25	19.6 ± 1

New info here?

**Service tools**

 - *Genuine Unicla tools*

 - *Optional generic tools*

**For UX-200 only**

**1** 03301-000750

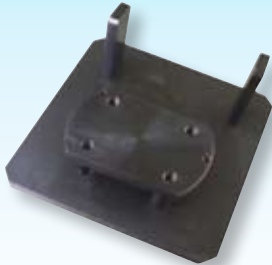

need pic

**For UP-200 only**

need pic

need pic

**4** 03301-000580



need pic

**3** 03301-000600



**5** 03301-000610



**9** 03301-000360



**10** 03301-000620



**8** 03301-000740



**16** 03301-000640



**15** 03301-000650



**6** 03301-000710

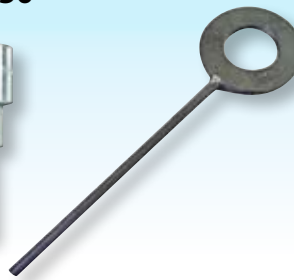

**7** 03301-000380



**18** 03301-000430



**19** 03301-000420



**13** 03301-000410



**17** 03301-000410



need pic

## Disassembly & reassembly procedure

### I. Removal of magnetic clutch armature

**Tools required:** • Stand (UX/UP) • Clutch wrench  
• Torque wrench • M6 Socket

**Procedure:** Place the compressor on the stand. Hold clutch wrench by inserting the claws of the clutch wrench into the holes on the armature. Remove the centre bolt by using the torque wrench. Pull the armature upwards.

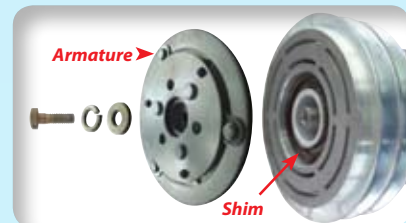
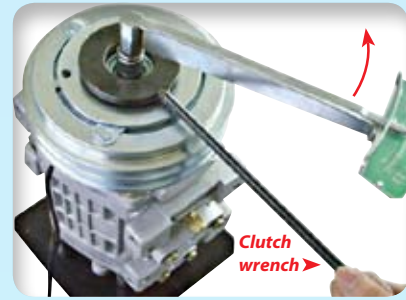

### II. Removal of snap ring

**Tools required:** • Snap ring pliers (*shaft*)

**Procedure:** Remove the snap ring by the snap ring pliers.



### III. Removal of pulley

**Tools required:** • Pulley remover • Standard wrench  
• Pulley remover pad



### IV. Removal of coil

**Tools required:** • Standard screwdriver

**Procedure:** Remove 3 M6 bolts with screwdriver

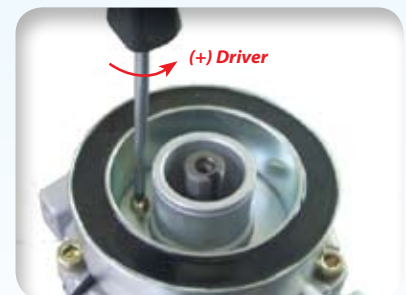

### V. Inspection of magnetic clutch components

**Armature** - Contact surfaces must be clean, smooth and unmarked, with no abnormal scoring

**Pulley** - As above. Ensure bearings run smoothly

**Coil** - Wiring harness must be in good condition



## Magnetic clutch installation

### I. Installation of magnetic coil

**Tools required:** • Stand (UP/UX) • Standard screwdriver

**Procedure:** Tighten 3 bolts (*wire must be visible at 3 o'clock position, when viewed from the front*).

**Tightening torque:**  $5.9 \pm 1 \text{ N}\cdot\text{m}$

### II. Installation of pulley

**Tools required:** • Pulley installer • Plastic hammer

**Procedure:** Place the pulley on the nose top and install it by tapping on the installer until it stops. Do not tap if the pulley is not located correctly.

### III. Installation of clutch key and snap ring

**Tools required:** • Snap ring pliers (*shaft*)

**Procedure:** Install the snap ring into the groove (*tapered side up*)

### IV. Installation of shims and armature

**Tools required:** • Guide pin

**Procedure:** Install the guide pin into the centre threaded hole of the shaft and select shims ( $T=0.1, 0.3$  and  $0.5\text{mm}$ ) to ensure the clutch clearance as in figure.

### V. Installation of armature

**Tools required:** • Clutch wrench • Torque wrench  
• M6 Socket

**Procedure:** Place washers and spring washers on M6 by holding the clutch wrench on the holes (*3 positions*) on the armature. **Tightening torque:**  $19.6 \pm 1 \text{ N}\cdot\text{m}$

### VI. Air gap

**Tools required:** • Thickness gauge

**Procedure:** Ensure clutch clearance is correct all around. ( $0.3\text{mm} \leq \text{gap} \leq 0.6\text{mm}$ )

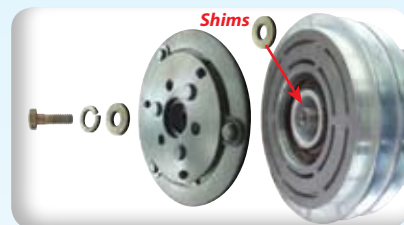
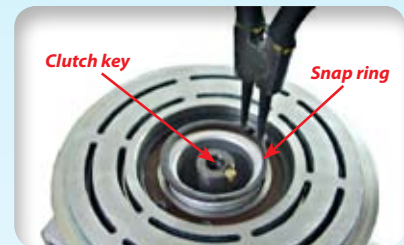
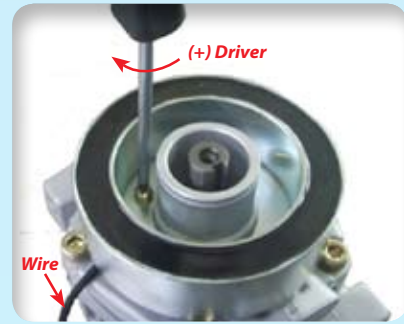

## Removal of lip seal

### I. Removal of the felt

**Procedure:** Removal of the felt on the shaft by hooking with the slender bar.

### II. Removal of snap ring

**Tools required:** • Snap ring pliers (*hole*)

**Procedure:** Remove the snap ring slowly with pliers as shown in the figure.

### III. Removal of lip seal

**Tools required:** • Lipseal remover

**Procedure:** Insert the lip seal into the recess as shown in the figure, turn around lightly and pull out.

### IV. Inspection of lip seal

1. **Felt seal** - *should be dry.*
2. **Snap ring** - *must be in one piece and not deformed.*
3. **Lip seal.**

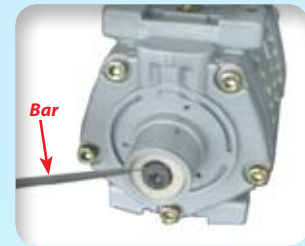

## Installation of lip seal

### I. Setting the guide sleeve

**Tools required:** • Stand • Guide sleeve

**Procedure:** Place compressor on the stand. Lubricate outside of the guide sleeve and insert into the shaft of the compressor.

**Caution - the sleeve must be clean and unmarked.**

### II. Installation of lip seal

**Tools required:** • Guide sleeve • Lipseal installer

**Procedure:** Slice the lipseal over the guide sleeve. Place the remover on the lip seal correctly and press the lipseal with the remover until it stops. Then remove the guide sleeve.

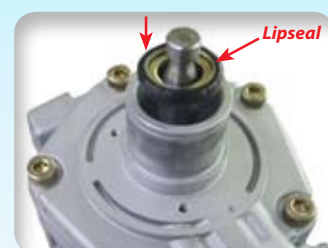

## Installation of lip seal - *continued*

### III. Assembly of the snap ring

**Tools required:** • Snap ring pliers (*hole*) • Installer ring

**Procedure:** Insert the snap ring into nose section (*tapered part of the snap ring must be facing downwards as shown in photo*). Push the snap ring downward with the remover, and fit into groove.

### IV. Assembly of the felt seal

**Tools required:** • Installer ring

**Procedure:** Install the felt seal into the nose section. Push the felt seal until it touches the snap ring.



## Disassembly of the body

**Caution - O-ring should not be reused.**

### I. Removal of oil

**Procedure:** Remove the drain plug and drain the oil.

### II. Removal of lipseal (Refer to page 9 for instructions)

### III. Removal of the bolts on rear cap

**Tools required:** • Socket wrench (*hexagon*) 10mm • Stand

**Procedure:** Remove the M10 securing bolts (*5pcs*) from the rear cap.

### IV. Removal of the rear cap

**Procedure:** Remove the rear cap by gently inserting a screw driver or lever into the recess. Lever all around, not just at one position.

**Caution - Do not damage the end of front cap and body.**

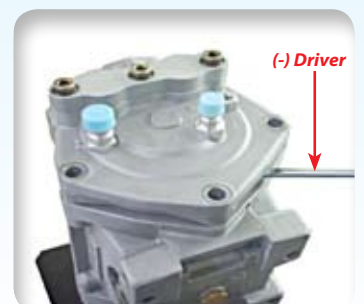

## V. Removal of rear valve

**Procedure:** Remove gasket, valve plate and suction valve. Remove the working assembly by pressing the end of the shaft into the front of the body as shown.

## VI. Removal of front valve and working assembly

**Procedure:** After removal of the cylinder, remove gasket, valve plate and suction valve from the front side.

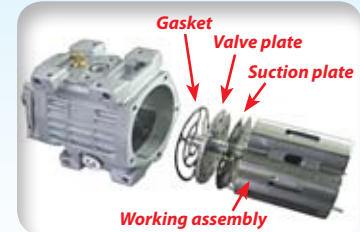

## Assembly of the body

### I. Installation of the O-ring for front and rear cap

**Procedure:** The o-ring must be free from marks and dust. Thoroughly lubricate new o-ring properly and insert into the groove. Ensure the o-ring is lying straight in the groove without a twist.



### II. Installation of the front cap

**Tools required:** • Torque wrench

**Procedure:** Place the body with front section facing upward. Place the front cap on the body (*be careful not to twist the o-ring*). Tighten M10 bolts (5pcs) with torque wrench.

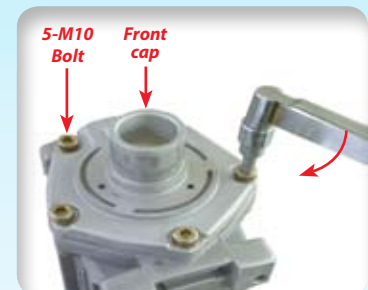

**Tightening torque: 34.3 ±1 N•m**

### III. Installation of the front valve plate and body

**Tools required:** • Working assembly bench

**Procedure:** Place the working assembly on locating pins. Stack the suction plate, the valve plate and gasket on locating pins in sequence as shown in the figure. Carefully lower the body over the working assembly until it stops next to the working bench guide.

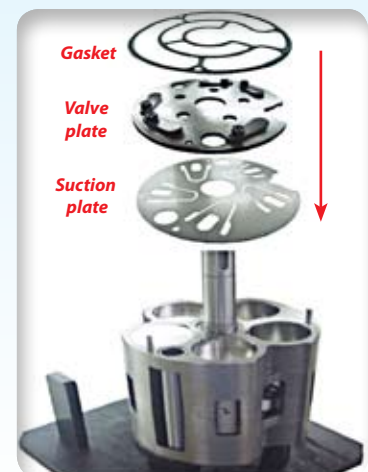

## Assembly of the body - *continued*

### IV. Installation of the rear valve plate and rear cap

**Tools required:** • Stand

**Procedure:** Place the body in an inverted position on the stand and stack the suction plate, valve plate and gasket in the figure. Thoroughly lubricate and install the o-ring into the rear cap groove. Ensure the o-ring is lying straight in the groove without any twists.

### V. Inspection, tightening and clearance of the rear cap

**Tools required:** • Torque wrench • Hexagon socket  
• Thickness guage

**Procedure:** Tension the M10 Hexagonal flange bolts (5pcs) diagonally, alternately and carefully. Check the rear cap clearance as specified:  $0.3 \leq \text{Gap} \leq 1.2\text{mm}$

**Tightening torque:  $34.3 \pm 1 \text{ N}\cdot\text{m}$**

### VI. Installation of lipseal (Refer to page 9 for instructions)

### VII. Test working assembly rotation

**Tools required:** • Shaft rotating handle

**Procedure:** Install the handle into the front section to check the shaft rotates smoothly.

### VIII. Filling compressor oil

**Procedure:** Fill the following amount of oil from the low pressure charge port as shown in the photo. Ensure drain correctly plugged.

**Standard oil type: Unidap 7 (PAG) or Unidap 6 (POE)**  
**Amount of oil =  $180 \pm 20 \text{ cc}$**

### IX. Plug cap on oil port

**Procedure:** Tighten high/low pressure port caps with M8 bolts.

**Tightening torque:  $24.5 \pm 1 \text{ N}\cdot\text{m}$**

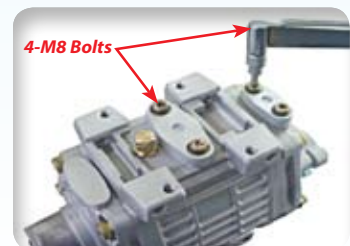
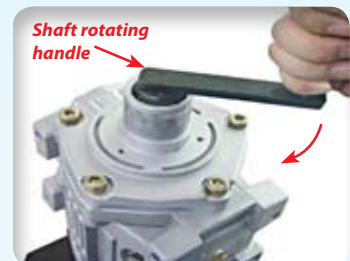

## System oil quantity

The correct amount of oil must be maintained in the compressor and system. Long hose runs and dual evaporator systems must have additional oil added to the system. Severe oil starvation problems may result from insufficient system oil being allowed. To determine oil quantity required, Unicla recommends a calculation as a percentage of refrigerant charge as follows:

- **20% for UP/UX200 compressors** in standard applications where the suction and discharge lines are less than 6 metres in length.
- **30% for UP/UX200 compressors** in applications where suction and discharge lines exceed 6m in length.

### Example:

Calculate oil charge as 20% of refrigerant charge, 5 kg charge = 5000 g x 20% = 1000 ml (cc) of oil. If fitting a UP/UX200 compressor, then deduct the compressor initial oil charge to determine amount of oil to be added. Therefore 1000 – 600 = 400cc oil to be added to system.

## Oil type and grade

Each Unicla UP/UX200 is fitted with either PAG oil (*Unidap 7*) or POE oil (*Unidap 6*). When adding oil to the system, Unicla oil must be used. **⚠️Warranty is void if these guidelines are not followed.**

Compressor Model	Refrigerant	Oil Type (Unicla)	Viscosity @ 40°C	Viscosity @ 100°C	Application	Low side Saturation	Oil Separator
UP200	R134a	Unidap 7	48.01	10.51	Airconditioning	> 0°C	Optional
UX200	R134a	Unidap 6	65.5	9.3	Airconditioning	>0°C	Optional

**The following labels will determine the type of oil in each UX330 compressor:**



POE type

need pics?



PAG type

need pics?

## Storage guidelines

- Evacuate compressor for 3 minutes and fill with nitrogen (N<sup>2</sup>) at 0.1 ~ 0.2 MPa.
- Place the compressor in a clean and dry area with low humidity and tag with details.
- Keep compressor away from direct sunlight.
- Store the compressor horizontally on a flat, even surface.
- Do not store the compressor in temperatures above 30°C.
- Place the compressor in a well ventilated area to avoid corrosion damage.



Unicla International Limited  
Unit 1209-1210, 12F Manhattan Centre,  
8 Kwai Cheong Rd, Kwai Chung, N.T.,  
Hong Kong

Phone (852) 2422 0180  
Fax (852) 2422 0680  
Email: [sales@unicla.hk](mailto:sales@unicla.hk)  
Website: [www.unicla.hk](http://www.unicla.hk)

**need cat no**